

REJUVENATION®

Deck Mount Tub Filler with Hand Shower

PARTS INCLUDED

1 - Hose



2 - Hand Shower (includes washers)



3 - Hand Shower Cradle (includes washers)



4 - Hook ups

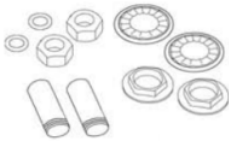

5 - Deck mount couplers with washers



6 - Faucet Body with Metal Cross Handles

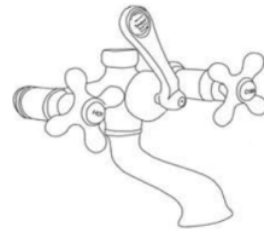

INSTALLATION

This bathroom fixture has been carefully engineered to provide a long, trouble-free service life under normal usage. It has been factory-tested and is ready for installation.

This fixture must be installed by a qualified licensed plumber for the warranty will remain in effect. We also strongly recommend tub & hardware be on site prior to rough in.

1. Shut off the water supply valves before installation.
2. Please use Teflon tape on all threaded connections available at your local hardware or plumbing supply.
3. Installations can vary depending on how previous fixtures were installed. Necessary supplies to install your faucet are not all included; however, they are available wherever plumbing supplies are sold.
4. Connect the shorter threaded end of hook up nipples (4) to the deck mount couplers (5). Insert the faucet through the 2 holes in the tub. Screw the locknuts onto the threaded nipples & tighten. 5. Tighten the nuts of the deck mount couplers (5) to the faucet body (6).
5. Place the washer inside the nut at the bottom of the hand shower cradle (3) and connect the cradle to the faucet & tighten.
6. Attach the hand shower hose (1) to the outlet of the handshower cradle (3) and to the hand shower (2). Place the hand shower on cradle.
7. If anti-siphon valve (not included) is used, it will be inserted between the cradle and the hose.

CLEANING INSTRUCTIONS

To maintain and protect the luster of all products, clean with a soft, damp cloth only.